

SDM100 Compatibility Requirements

Rear of the photovoltaic (PV) panel needs to be free of obstructions for the SDM100 attachment area.

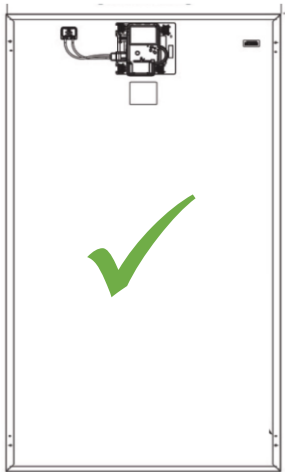

Typical
60 cell
panel

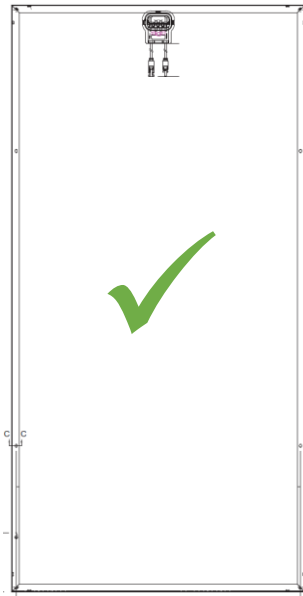

Typical
72 cell
panel

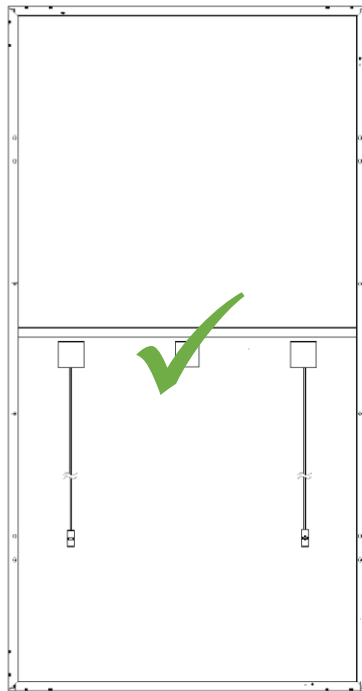

Typical 144
half cell
panel

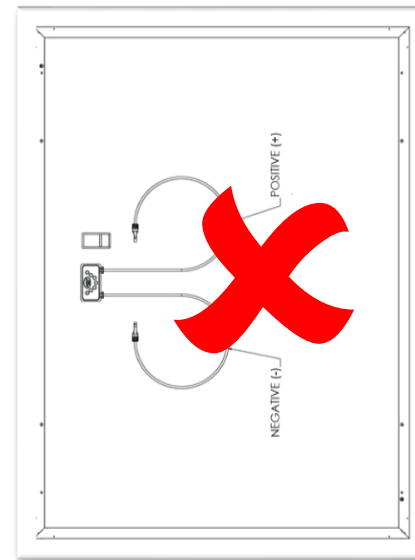

Junction Box
obstructs
long side of
panel

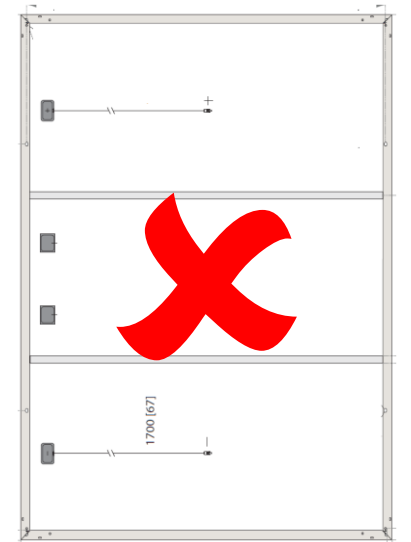

Junction Box
and supports
obstruct rear of
panel

Rear of Typical 60 or 72 cell panel

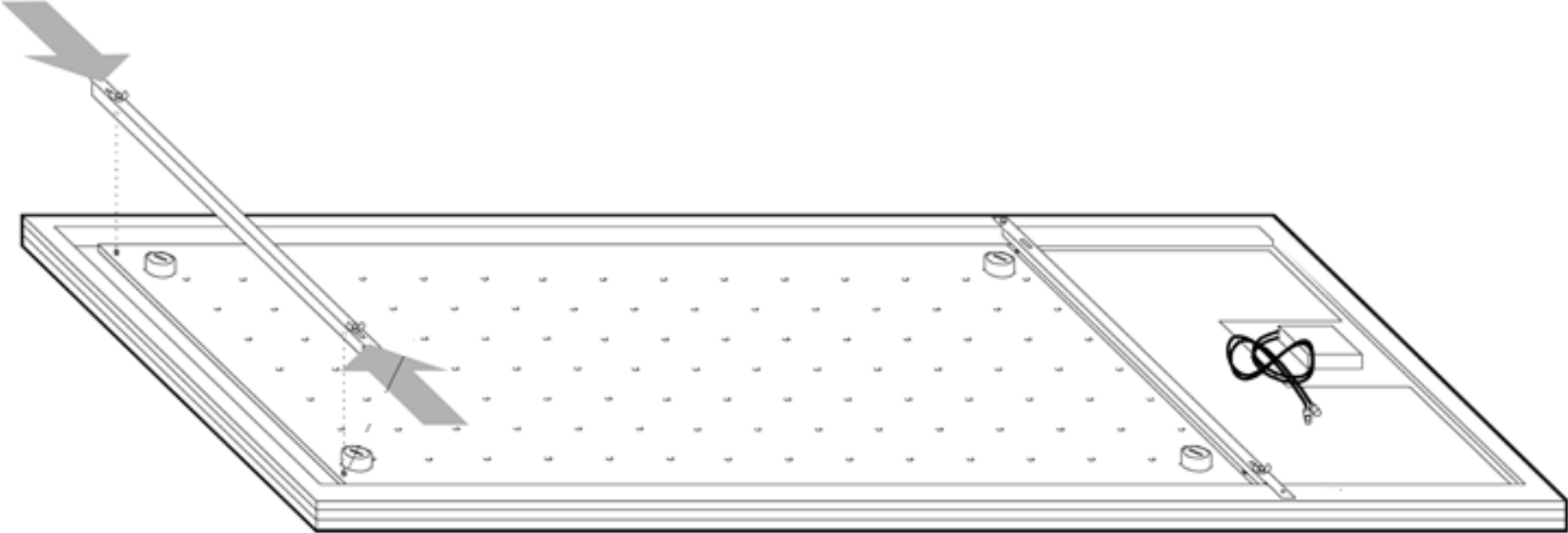

SDM100-900, 900Wt collector using a 144 half cell PV panel is made using two SDM100-450 Collectors on each side of the junction boxes. PV panels must have at least 33 x 37" clearance On each side of the junction boxes for the SDM100-450 to fit.

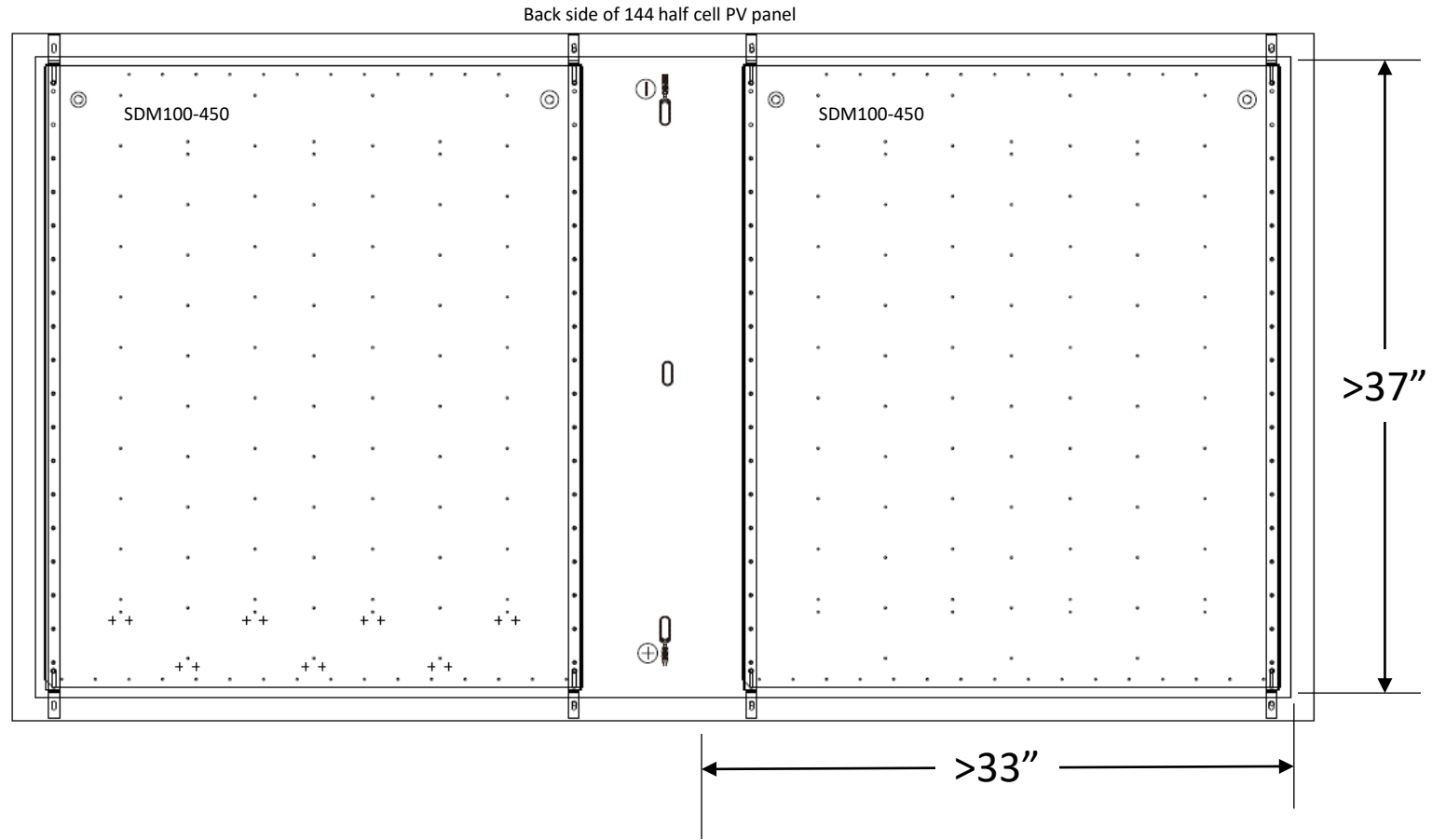

PV panel must have frame with lip for Brackets friction clamps

